



VIPROXY®

Valve with **I**ntegrated **P**ressure **R**egulator for medical **OXY**gen



- ✱ Compact and light design
- ✱ User friendly
- ✱ Suitable for use in multiple treatment settings

Breathe easy

Peace of mind therapy

NEW

Part Number MVA2EOS037

Features

- NEOS incorporates a low torque non rotating spindle shut off valve with an integrated ten position flow selector
- Valve with integrated pressure regulator for Medical Oxygen, MRI compatible certified up to 3 Tesla
- Non-return valve with sintered bronze filter integrated in the filling port
- Piston regulator
- Sintered bronze smart filter in the cylinder connection
- Tested and approved in accordance with the International Standards EN ISO 10524-3, CGA E-18
- Residual pressure device incorporated
- Digital gauge with backlight display

Technical data

Pressure

Maximum Service Pressure	3,360 PSI
Outlet Pressure	50 PSI
Residual Pressure Range	43 - 72 PSI

Operative Temperature Range 32°F ÷ +122°F

Shut Off Valve Life Cycle 4,000 minimum

Flow Rate 2,400 NI/min

Hose-barb Ø 1/4"

Flow Rates 0.5, 1, 1.5, 2, 3, 4, 6, 8, 10, 15, 25 l/min

Material components

Chromium plated brass body
 Valve Main Sealing in Nylon
 Regulator Sealing in Nylon
 Elastomer in EPDM
 The valve is not made of any ferrous material or steel

Ordering Information

Part Number	Inlet	Fill Connection	Bursting Disc	Cylinder Type
MVA2EOS037	.750-16 UNF2A	CGA 540	3,360 PSI	ME
3079500153	Guard for MVA2UOS037			
3071100380	Display Cover			
3079500123	Control Group			

Fill Adapters:

CGA	Part Number	Description
CGA 540	PBX55400	CGA 540 x CGA 540 Short Fixed Pin
CGA 540	PBX85400	CGA 540 Short Fixed Pin, Handtight

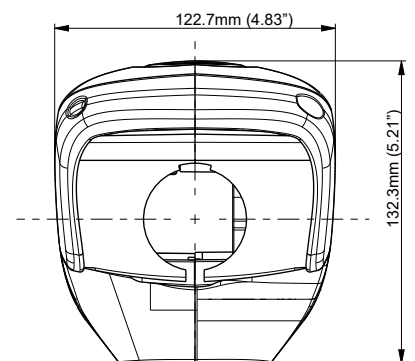
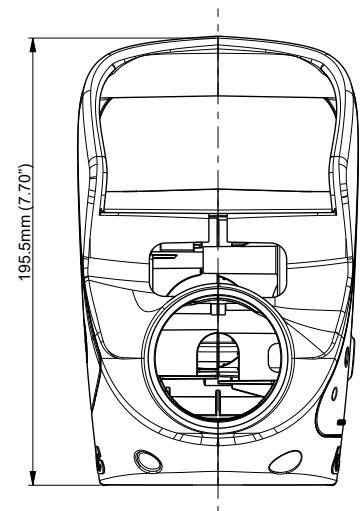

Features

- 1 Touch incorporates a low torque non rotating spindle shut off valve with an integrated ten position flow selector device
- Valve with integrated pressure regulator for Medical Oxygen, MRI compatible certified up to 3 Tesla
- Non-return valve with synerized bronze filter integrated in the filling port
- Piston regulator
- Synerized bronze smart filter in the cylinder connection
- Tested and approved in accordance with the International Standards EN ISO 10524-3, CGA E-18
- Residual pressure device incorporated
- Active gauge with fluorescent screen

Technical data

Pressure

Maximum Service Pressure	3,360 PSI
Outlet Pressure	50 PSI
Residual Pressure Range	43 - 72 PSI

Temperature Range -40°F ÷ +149°F

Life Cycle 4,000 minimum

Flow Rate 2,400 NI/m

Hose-barb Ø 1/4"

Flow Rates 0.5, 1, 1.5, 2, 3, 4, 6, 8, 10, 15, 25 l/m

Material components

Body in forged brass
Valve Main Sealing in Nylon
Regulator Sealing in Nylon
Elastomer in EPDM
The valve is not made of any ferrous material or steel

Ordering Information

Part Number	Inlet	Fill Connection	Bursting Disc	Cylinder Type
MVA2UOS010	.750 UNF	CGA 540	3360 PSI	ME
3079500050	Guard for MVA2UOS010			

Filling Adapters:

CGA	Part Number	Description
CGA 540	PBX55400	CGA 540 x CGA 540 Short Fixed Pin
CGA 540	PBX85400	CGA 540 Short Fixed Pin, Handtight



Part Number MVA2UOS010

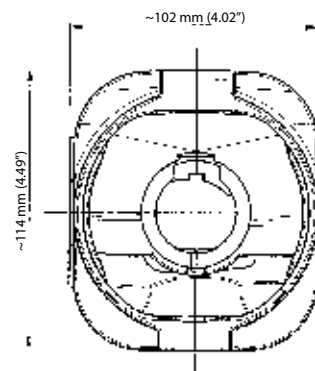
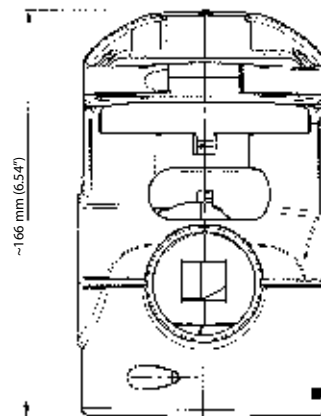

Features

- 1 Touch incorporates a low torque non rotating spindle shut off valve with an integrated ten position flow selector device
- Valve with integrated pressure regulator for Medical Oxygen, MRI compatible certified up to 3 Tesla
- Non-return valve with synerized bronze filter integrated in the filling port
- Piston regulator
- Synerized bronze smart filter in the cylinder connection
- Tested and approved in accordance with the International Standards EN ISO 10524-3, CGA E-18
- Residual pressure device incorporated
- Active gauge with fluorescent screen

Technical data

Pressure

Maximum Service Pressure	3,360 PSI
Outlet Pressure	50 PSI
Residual Positive Pressure	43 - 72 PSI

Temperature Range	-40°F ÷ +149°F
--------------------------	----------------

Life Cycle	4,000 minimum
-------------------	---------------

Flow Rate	2,400 NI/m
------------------	------------

Hose-barb Ø	1/4"
--------------------	------

Flow Rates	0.5, 1, 1.5, 2, 3, 4, 6, 8, 10, 15, 25 l/m
-------------------	--

Material components

Body in forged brass
Valve Main Sealing in Nylon
Regulator Sealing in Nylon
Elastomer in EPDM
The valve is not made of any ferrous material or steel

Ordering Information

Part Number	Inlet	Fill Connection	Bursting Disc	Cylinder Type
MVA2UOS002	.750 UNF	CGA 540	3360 PSI	ME
3079500112	Guard for MVA2UOS002			

Filling Adapters:

CGA	Part Number	Description
CGA 540	PBX55400	CGA 540 x CGA 540 Short Fixed Pin
CGA 540	PBX85400	CGA 540 Short Fixed Pin, Handtight



Part Number MVA2UOS002

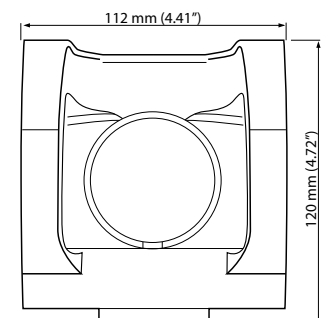
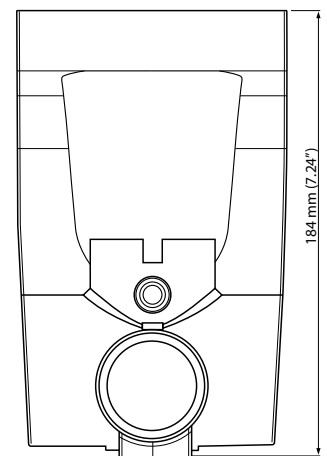

Features

- AirVIPR incorporates a low torque non rotating spindle shut off valve with an integrated ten position flow selector device
- Valve with integrated pressure regulator for Medical Air, MRI compatible certified up to 3 Tesla
- Non-return valve with synerized bronze filter integrated in the filling port
- Piston regulator
- Synerized bronze smart filter in the cylinder connection
- Tested and approved in accordance with the International Standards EN ISO 10524-3, CGA E-18
- Residual pressure device incorporated
- Active gauge with fluorescent screen

Technical data

Pressure

Maximum Service Pressure	3,360 PSI
Outlet Pressure	50 PSI
Residual Positive Pressure	43 - 72 PSI

Temperature Range -40°F ÷ +149°F

Life Cycle 4,000 minimum

Flow Rate 2,400 NI/m

Hose-barb Ø 1/4"

Flow Rates 1, 2, 3, 4, 6, 8, 10, 12, 15, 20, 25 l/m

Material components

Body in forged brass
Valve Main Sealing in Nylon
Regulator Sealing in Nylon
Elastomer in EPDM
The valve is not made of any ferrous material or steel

Ordering Information

Part Number	Inlet	Fill Connection	Bursting Disc	Cylinder Type
MVA2UAI001	.750 UNF	CGA 346	3360 PSI	ME
3079500166	Guard for MVA2UAI001			

Filling Adapters:

CGA	Part Number	Description
CGA 346	PBX23460	CGA 346 x CGA 346 Fixed Pin



Part Number MVA2UAI001

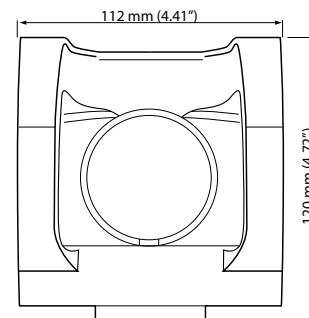
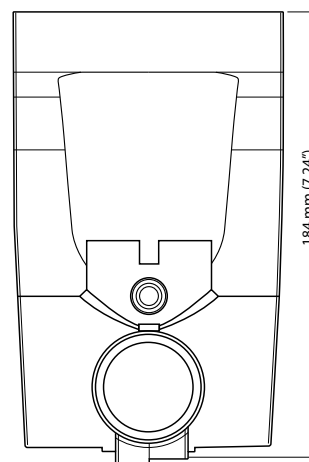

Key Features & Benefits

All in one solution

- Combines on/off with reduced pressure for direct patient care.
- A 35% lower profile than comparable models provides more efficient racking and storage capabilities
- 15 to 25% lighter weight than comparable models
- Ergonomically designed shroud with carrying handles improves mobility and reduces user fatigue
- Guard circumference is sized to fit within the footprint diameter of standard Medical-E cylinders

Reliable, Quality Product

- Flow rate accuracy within $\pm 10\%$ of dial setting
- Regulator adjustment knob with positive flow detents guard against inadvertent flow setting changes



1Touch & NEOS valves incorporate a low torque non rotating spindle shut off valve with an integrated ten position flow selector device.



Dual outlet (hose barb and fixed high pressure) covers all the possible applications of the Viproxy. Dual reading dials on the side and on the top of the flow selector allow easy reading from different angle perspectives.

An integrated pressure relief device is located in the low pressure section of the regulator.

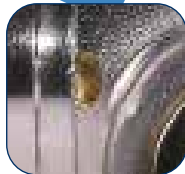

1Touch & NEOS valves incorporate also a residual pressure device, to protect the cylinder from accidental contamination.

1Touch & NEOS valves integrate a high flow piston regulator upper stream protected by a special labyrinth filter.



1Touch & NEOS valves can be equipped with a bursting disc device on the high pressure side depending on customer requirements. Various Pressure ratings are available.

NEOS gauge incorporates a low level alarm and backlights.

Red Backlight Indicating:

- Low O2 pressure level
- Low supply level
- Low Battery
- High/Low Temperature
- Filling state

White Backlight:

- Clearer view in dark environments

Technical features:

- Suitable for up to 300 bar oxygen service pressure (4350 PSI)
- Digital gauge available with PSI or bar scales (only for NEOS valve)
- Non-return valve in the filling port
- Conforms to all the requirements of CGA E-18 and EN ISO 10524-3
- MRI compatible certified up to 3 Tesla
- Conforming to the PILL test ASTM G-175 (up to 300 bar)
- 5 Years Battery Lifetime (only for NEOS valve)
- Gauge IP Rate: 65 (only for NEOS valve)
- Constant Measurement of pressure and temperature inside the cylinder (only for NEOS valve)
- Continuous Pressure Sampling (only for NEOS valve)
- Alerts for low content level and low battery (only for NEOS valve)

Additional features:

- Integrated hospital bed hanging device
- Protection guard conforming to ISO 11117
- Configuration customizable with 1 or 2 outlets. Barbed fitting for 1/4" I.D. hose and DISS quick connection
- Fixed pressure regulator at 50 PSI
- Bursting disc device up to 4350 PSI
- Excess flow device (OPTIONAL)
- Special smart filter cartridge (OPTIONAL)

Customizable with different flow-scales for: **Baby care, Home care and Intensive therapy.**
Shroud customizable in different colors.

Cavagna Group's HP stocking locations

Cavagna North America, Inc
50 Napoleon Court
Somerset, NJ 08873
Phone: 001-732-4692100
Fax: 001-732-4693344
Email: info@cavagna.com

Distribution Center:
Cavagna North America, Inc
5910 W By Northwest Blvd.
Houston, TX 77040
Email: info@cavagna.com

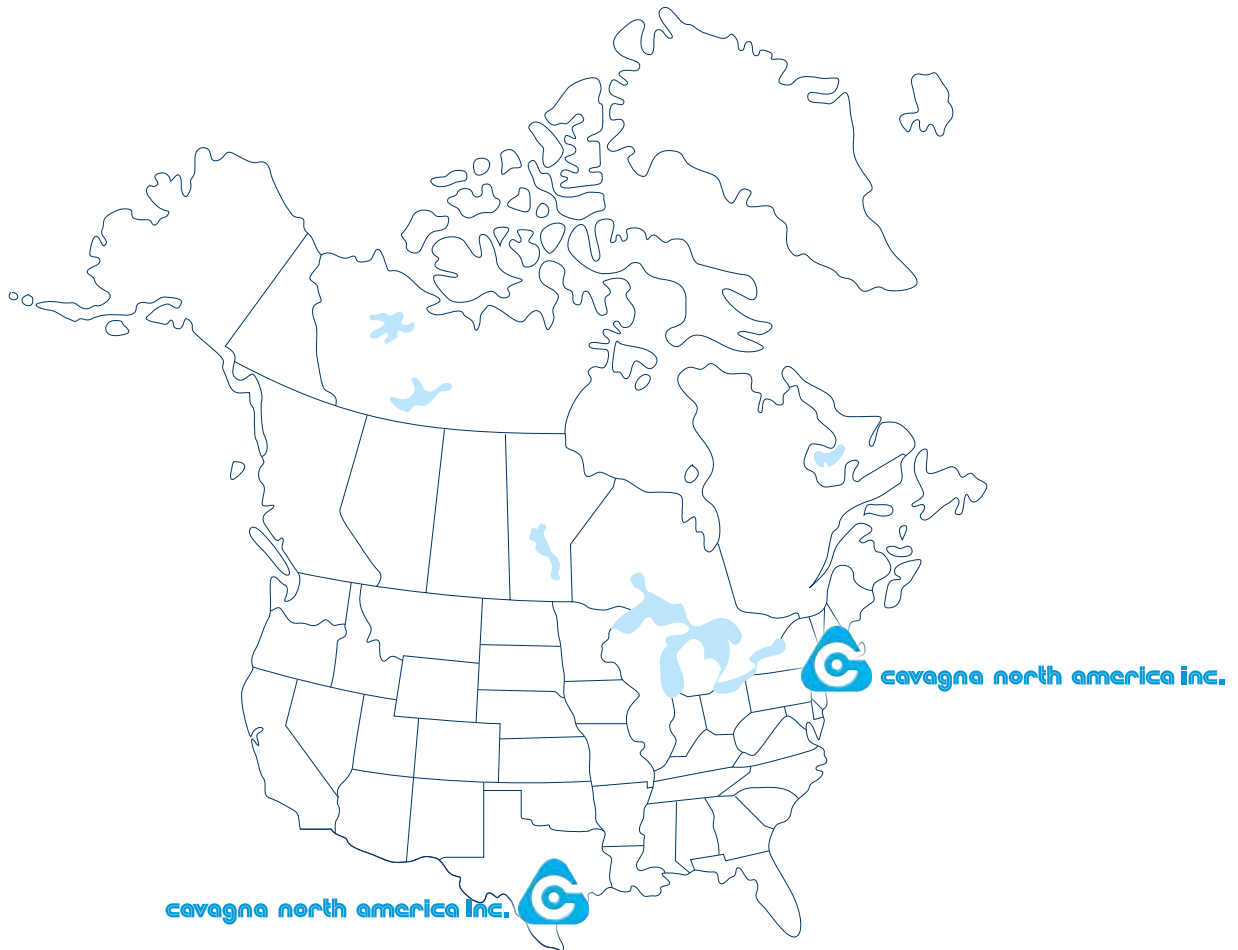

cavagna north america inc.

50 Napoleon Court Somerset, NJ 08873
732-469-2100 • Fax 732-469-3344

info@cavagna.com - www.cavagnana.com

